

Chassis ID	Path 8213/Repair//Hood Latch, Replacement
Model	Identity 120903347
Publish date 10/10/08	ID/Operation 8213-03-02-01

8213-03-02-01 Hood Latch, Replacement

You must read and understand the precautions and guidelines in Service Information, group 80, "General Safety Practices" before performing this procedure. If you are not properly trained and certified in this procedure, ask your supervisor for training before you perform it.

Removal

- 1
Unlatch and tilt the hood. If the hood can't be unlatched, remove the lower splash shield to loosen the latch bolts. Then tilt the hood to the upright position.
- 2
Push the hood latch lever back and pull the ball end of the cable out of the lever.
- 3
Mark the exact location of the receiver cup on the adjustment bracket.

Note: If the bracket bolts are loosened without first marking bolt locations, the hood adjustment procedure must be performed after replacement of the latch is complete. For hood adjustment see group 82.

4

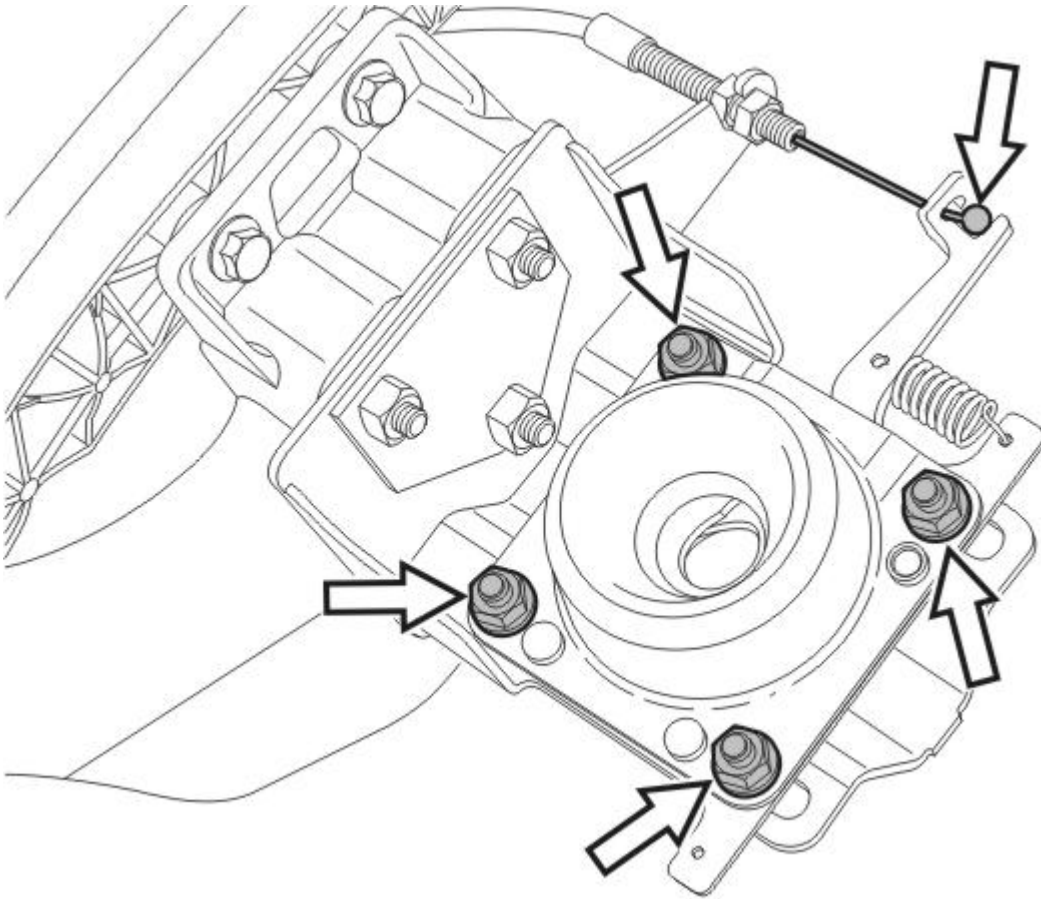

Remove the four hood latch mounting bolts. Remove the hood latch.

Installation

1

Install the hood latch and the hood latch mounting bolts. Torque the hood latch mounting bolts to 28 ± 5 Nm (21 ± 4 ft-lb).

Specifications:

28 ± 5 Nm (21 ± 4 ft-lb)

2

Push the hood latch lever back and install the ball end of the hood release cable.

Note: Check the release cable adjustment and readjust if necessary.

3

Reinstall the lower splash shield.